

ITEM 20:

Consider an amendment to the Honeymoon Island State Park Management Plan (Lease No. 3202).

LOCATION:

Pinellas County

APPLICANT:

Division of Recreation and Parks

DSL STAFF REMARKS:

The Division of Recreation and Parks (DRP) is requesting ARC approval of an amendment to the Honeymoon Island State Park (HISP) Land Management Plan. The DRP is requesting approval for a time sensitive land planning concept that must be conveyed for ARC review in advance of the recently submitted (as of November 3, 2021) draft management for Honeymoon Island State Park. The proposal is to construct a new vehicular access lane into the park with an additional tollbooth and other basic essential elements, e.g., signage and any associated electrical utilities. Addition of a stormwater retention feature is planned to capture displacement of water from the new impervious surface.

HISP is approximately 2,825 acres in size, located in Pinellas County approximately four miles northwest of downtown Dunedin, and only two miles from the mainland shoreline. The island is part of a chain of barrier islands that parallels Florida’s Gulf Coast. Access to the island is from the mainland via State Road 586 and the Dunedin Causeway since 1965.

STAFF RECOMMENDATION:

Approve the management plan amendment.

ARC RECOMMENDATION:

- APPROVE**
- APPROVE WITH MODIFICATIONS:** _____
- DEFER**
- WITHDRAW**
- NOT APPROVE**
- OTHER:** _____

Honeymoon Island State Park Entrance Redesign Concept



Florida Department of Environmental Protection
Division of Recreation & Parks

**Honeymoon Island State Park
Unit Management Plan Amendment, November 10, 2021**

Submittal

The Division of Recreation & Parks is requesting approval by the Acquisition & Restoration Council (ARC) of a land planning concept that is considered to be time sensitive and must be conveyed for ARC review in advance of the recently submitted (as of November 3, 2021) draft management for Honeymoon Island State Park. This submittal is being requested for consideration at the December 2021 ARC meeting. Details of the concept are provided in the following report and supplemented by a series of supporting maps and documents: parkwide natural communities map, broad conceptual land use map, site-specific project layout, permitting documents, and letters of local government and state agency review.

Concept Overview

The purpose of the project is to construct a new vehicular access lane into the park with an additional toll booth and other basic essential elements, e.g., signage and any associated electrical utilities. Addition of a stormwater retention feature is planned to capture displacement of water from the new impervious surface.

Honeymoon Island State Park is located in Pinellas County approximately four miles northwest of downtown Dunedin, and only two miles from the mainland shoreline. The island is part of a chain of barrier islands that parallels Florida's Gulf Coast. Access to the island is from the mainland via highway State Road 586 and the Dunedin Causeway since 1965. At Honeymoon Island State Park, public outdoor recreation is the designated single use of the property. No legislative or executive directives constrain the use of this conservation and recreation property. Honeymoon Island State Park is a regional and even statewide favorite destination for active beach recreation and passive interpretive nature study. It consistently ranks among the top five most visited parks in the Florida State Parks system. Park visitation continues to increase with the growth of the resident population and non-local tourism.

Need and Anticipated Benefits

Traffic Ingress

Project proposes to alleviate considerable traffic congestion and vehicular stacking that has caused private property access challenges and other nuisances for the adjacent condominium complex. Stalled traffic at the entrance and into the interior of the park also results in vehicle idling, visitor frustrations, and management access challenges. Alleviation of this congestion will offer significant benefit for visitors, managers, and area residents alike.

With optimal project outcomes, the entrance redesign will expedite access to an unchanged parking area. Carrying capacity and volume of visitation within the park will remain the same.

Alternative solutions were evaluated, entailing utilization of a new ranger station recessed further into the interior of the park along the existing park road and reconfiguration of traffic patterns, but were ruled out on the basis of various logistical factors.

In conjunction with the expanded entrance, bicycle and other forms of alternative park access are being additionally considered to reduce traffic congestion and parking shortages.

Florida Department of Environmental Protection
Division of Recreation & Parks

Potential Impacts to Natural and Cultural Resources

Terrestrial Ecological, Natural Communities/ Natural Resources

Project proposes to utilize existing areas of ground disturbance where natural vegetation is limited.

Entrance area of the park is considered altered landcover types to both sides of the road. The site is characterized by an abundance of sabal palms and scrubby vegetation associated with the nearby coastal grassland and beach dunes. Some direct and indirect impacts to the intact coastal grassland community may occur. Dependent on soil conditions and other onsite variables, replanting efforts may offset this aesthetic and/or ecological impact. Established natural features could be restored by new tree and shrub installations. Impacts may be summarized as mild to moderate on an altered landscape, with an acceptable net loss in natural surface and vegetated groundcover.

This site has long history of impacts and landscape alterations resulting from:

- road construction and maintenance
- sand deposition/fill projects
- WWII-era military training uses
- 1930s-era vacation uses

A current retention pond exists but will need to be expanded to match engineering specifications:

- Existing pond surface area: 20,500 square feet
- Proposed pond surface area: 36,528 square feet

A gopher tortoise survey was completed, finding two gopher tortoises within 25 feet of the construction project limits. These gopher tortoises will be relocated within the park according to FWC permitting requirements and best practices.

Marine Ecological, Natural Communities/ Natural Resources

Park boundary encompasses extensive submerged lands, significant for seagrass beds and sporadic soft coral and sponge features. Various natural features and habitats are located within the vicinity of the project, but outside of the affected areas. Seagrass beds are fringed partially by marine tidal swamp, which is significant for wading bird habitat and general biodiversity. Narrow extensions of wet sand beach provide foraging habitat for shorebird species. Mollusk species may also be found throughout the marine natural communities.

The entrance project does not entail sand deposition or any upland expansion, such that no impacts to water quality or submerged vegetation/wildlife are anticipated.

Cultural Resources

Cultural resource impacts within this narrow and previously altered coastal site are unlikely but will be assessed prior to any ground-disturbing activity.



Honeymoon Island State Park Natural Communities Map

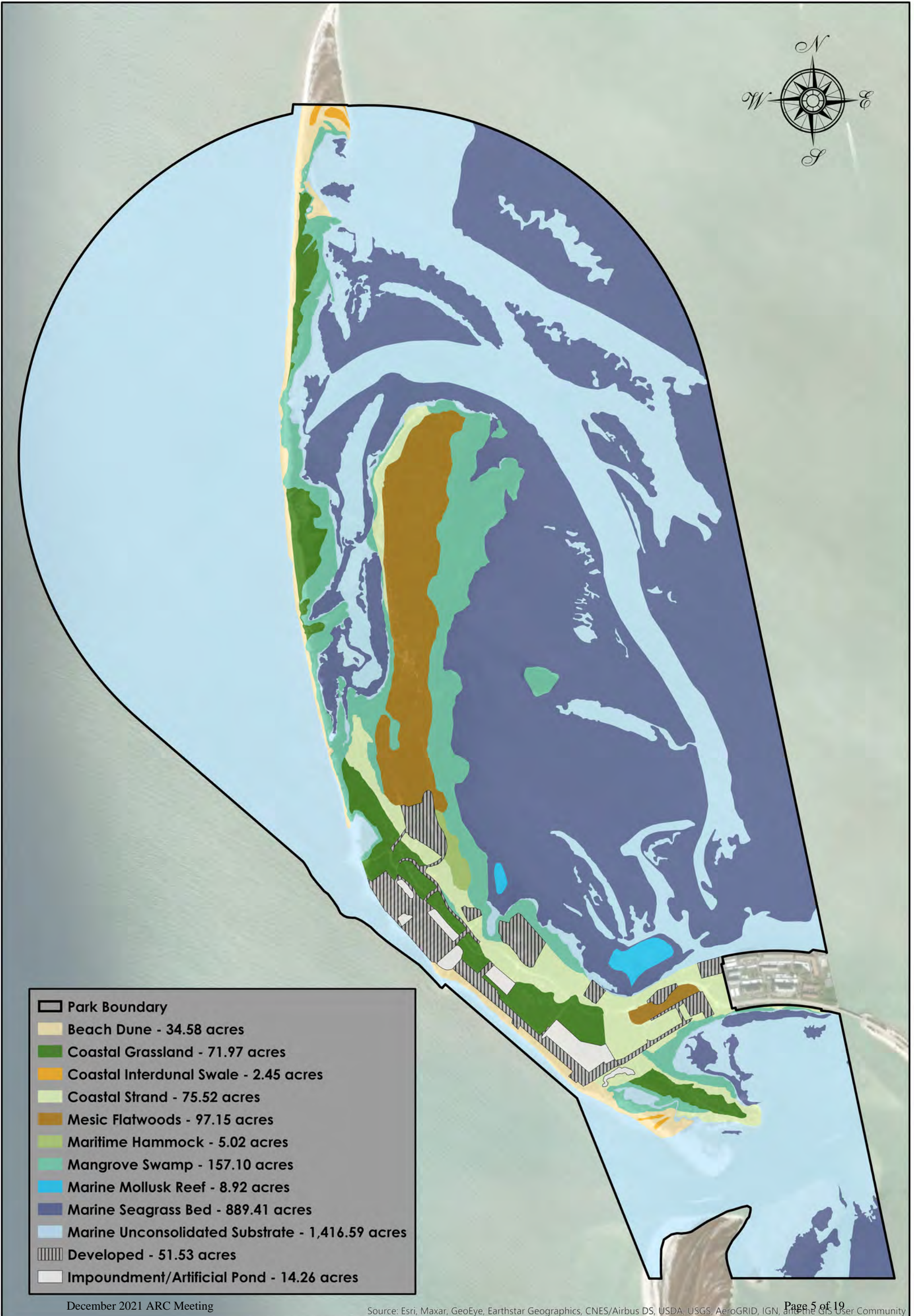
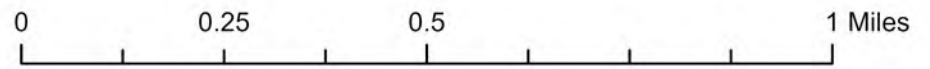

- Park Boundary
- Beach Dune - 34.58 acres
- Coastal Grassland - 71.97 acres
- Coastal Interdunal Swale - 2.45 acres
- Coastal Strand - 75.52 acres
- Mesic Flatwoods - 97.15 acres
- Maritime Hammock - 5.02 acres
- Mangrove Swamp - 157.10 acres
- Marine Mollusk Reef - 8.92 acres
- Marine Seagrass Bed - 889.41 acres
- Marine Unconsolidated Substrate - 1,416.59 acres
- Developed - 51.53 acres
- Impoundment/Artificial Pond - 14.26 acres



Honeymoon Island State Park

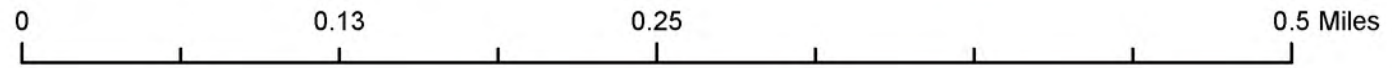

- Park Boundary
- Water
- Structures
- Parking Areas
- Park Road Paved
- Park Road Stabilized
- Park Road Unstabilized
- Bike Trail
- Nature Trail
- Walkways

Entrance Area
 Renovate ranger station/office
 Develop automated entry lane

Entrance Area
 Develop turn-around traffic circle

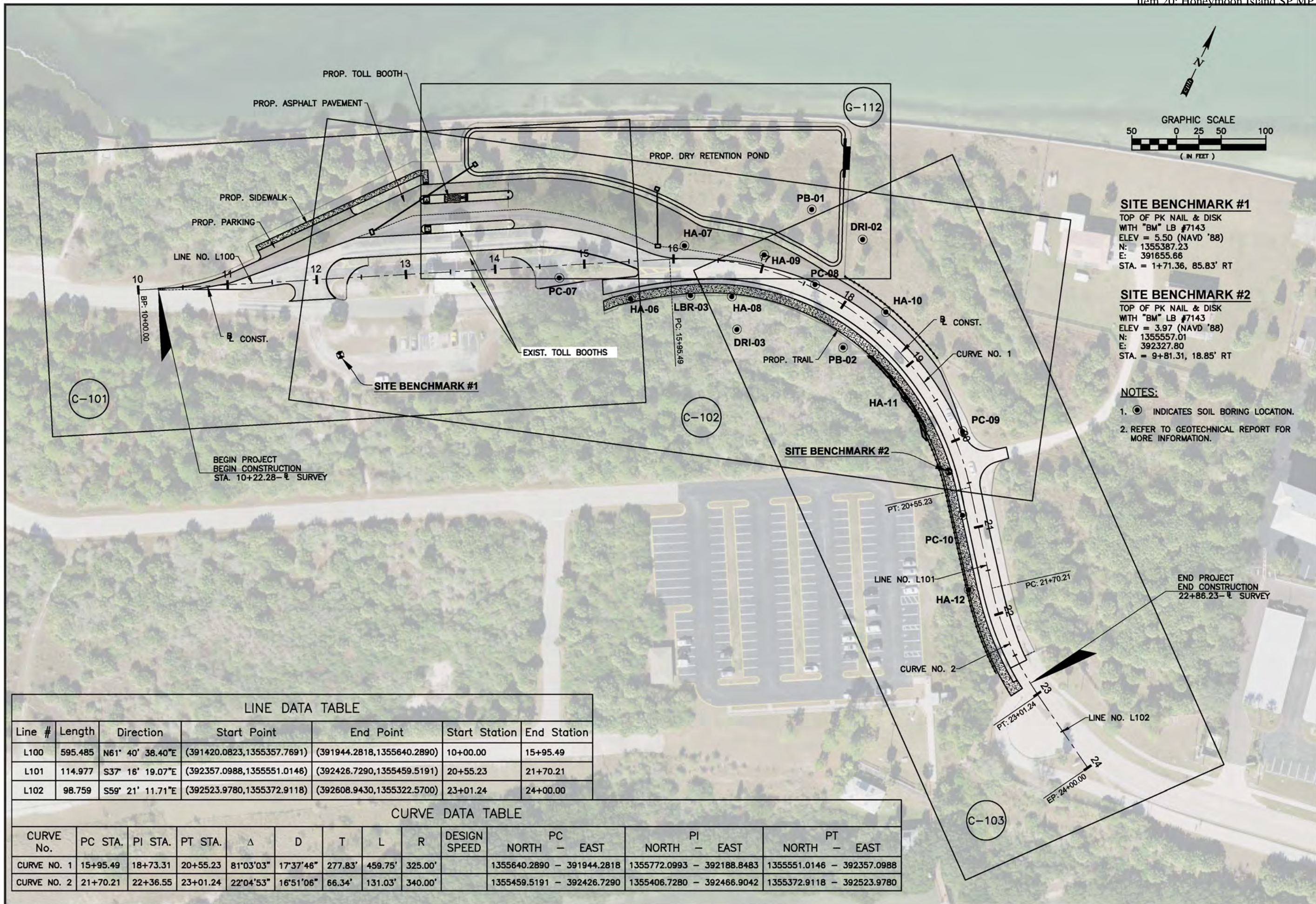

SITE BENCHMARK #1
 TOP OF PK NAIL & DISK
 WITH "BM" LB #7143
 ELEV = 5.50 (NAVD '88)
 N: 1355387.23
 E: 391655.66
 STA. = 1+71.36, 85.83' RT

SITE BENCHMARK #2
 TOP OF PK NAIL & DISK
 WITH "BM" LB #7143
 ELEV = 3.97 (NAVD '88)
 N: 1355557.01
 E: 392327.80
 STA. = 9+81.31, 18.85' RT

- NOTES:**
1. ● INDICATES SOIL BORING LOCATION.
 2. REFER TO GEOTECHNICAL REPORT FOR MORE INFORMATION.

BEGIN PROJECT
 BEGIN CONSTRUCTION
 STA. 10+22.28 - SURVEY

END PROJECT
 END CONSTRUCTION
 22+86.23 - SURVEY

LINE DATA TABLE

Line #	Length	Direction	Start Point	End Point	Start Station	End Station
L100	595.485	N61° 40' 38.40"E	(391420.0823,1355357.7691)	(391944.2818,1355640.2890)	10+00.00	15+95.49
L101	114.977	S37° 16' 19.07"E	(392357.0988,1355551.0146)	(392426.7290,1355459.5191)	20+55.23	21+70.21
L102	98.759	S59° 21' 11.71"E	(392523.9780,1355372.9118)	(392608.9430,1355322.5700)	23+01.24	24+00.00

CURVE DATA TABLE

CURVE No.	PC STA.	PI STA.	PT STA.	Δ	D	T	L	R	DESIGN SPEED	PC		PI		PT					
										NORTH	EAST	NORTH	EAST	NORTH	EAST				
CURVE NO. 1	15+95.49	18+73.31	20+55.23	81°03'03"	17°37'46"	277.83'	459.75'	325.00'			1355640.2890	-	391944.2818	1355772.0993	-	392188.8483	1355551.0146	-	392357.0988
CURVE NO. 2	21+70.21	22+36.55	23+01.24	22°04'53"	16°51'06"	66.34'	131.03'	340.00'			1355459.5191	-	392426.7290	1355406.7280	-	392466.9042	1355372.9118	-	392523.9780

DATE	REVISION	SYMBOL	DATE	REVISION	SYMBOL
ISSUE DATE: 01/12/18	COMPL. FILE No: F13609	STATE PROJECT No: 61199C	DESIGNER: J.M.L.	DRAWN BY: P.E.A.	REVIEWED BY: A.P.E.
PROFESSIONAL REGISTRATION			CONSULTANT:		
HONEYMOON ISLAND STATE PARK			PROJECT TITLE		
PROJECT LAYOUT			ENTRANCE AREA IMPROVEMENTS		
SHEET NO.			G-104		

Department of Environmental Protection
 Office of Operations
 Bureau of Design and Construction
 3800 Commonwealth Blvd., Tallahassee, FL 32399 (905) 425-2300

**Honeymoon Island
State Park
Entrance Redesign Concept
Supporting Documents of
Permitting and Inter-agency
Review**



Southwest Florida Water Management District

2379 Broad Street, Brooksville, Florida 34604-6899
(352) 796-7211 or 1-800-423-1476 (FL only)
SUNCOM 628-4150 TDD only 1-800-231-6103 (FL only)
On the Internet at: WaterMatters.org

An Equal
Opportunity
Employer

Bartow Service Office
170 Century Boulevard
Bartow, Florida 33830-7700
(863) 534-1448 or
1-800-492-7862 (FL only)

Sarasota Service Office
78 Sarasota Center Boulevard
Sarasota, Florida 34240-9770
(941) 377-3722 or
1-800-320-3503 (FL only)

Tampa Service Office
7601 Highway 301 North
Tampa, Florida 33637-6759
(813) 985-7481 or
1-800-836-0797 (FL only)

March 20, 2020

Florida Department of Environmental Protection
Attn: Michael Foster
3800 Commonwealth Blvd. 260H. MS 520
Tallahassee, FL 32399

Subject: **Notice of Intended Agency Action - Approval
ERP Individual Construction Major Modification**
Project Name: Honeymoon Island State Park Entrance Improvements
App ID/Permit No: 796220 / 43014692.002
County: Pinellas
Sec/Twp/Rge: S08/T28S/R15E

Dear Permittee(s):

The Southwest Florida Water Management District (District) has completed its review of the application for Environmental Resource Permit modification. Based upon a review of the information you have submitted, the District hereby gives notice of its intended approval of the application.

The File of Record associated with this application can be viewed at <http://www18.swfwmd.state.fl.us/erp/erp/search/ERPSearch.aspx> and is also available for inspection Monday through Friday, except for District holidays, from 8:00 a.m. through 5:00 p.m. at the District's Tampa Service Office, 7601 U.S. Highway 301 North, Tampa, Florida 33637.

If you have any questions or concerns regarding the application or any other information, please contact the Environmental Resource Permit Bureau in the Tampa Service Office.

Sincerely,

David Kramer, P.E.
Bureau Chief
Environmental Resource Permit Bureau
Regulation Division

cc: David Landers
Ariel Elvambuena, P.E., CPH Corp



Southwest Florida Water Management District

2379 Broad Street, Brooksville, Florida 34604-6899
(352) 796-7211 or 1-800-423-1476 (FL only)
SUNCOM 628-4150 TDD only 1-800-231-6103 (FL only)
On the Internet at: WaterMatters.org

An Equal
Opportunity
Employer

Bartow Service Office
170 Century Boulevard
Bartow, Florida 33830-7700
(863) 534-1448 or
1-800-492-7862 (FL only)

Sarasota Service Office
78 Sarasota Center Boulevard
Sarasota, Florida 34240-9770
(941) 377-3722 or
1-800-320-3503 (FL only)

Tampa Service Office
7601 Highway 301 North
Tampa, Florida 33637-6759
(813) 985-7481 or
1-800-836-0797 (FL only)

March 20, 2020

Florida Department of Environmental Protection
Attn: Michael Foster
3800 Commonwealth Blvd. 260H, MS 520
Tallahassee, FL 32399

**Subject: Notice of Agency Action - Approval
ERP Individual Construction Major Modification**

Project Name: Honeymoon Island State Park Entrance Improvements
App ID/Permit No: 796220 / 43014692.002
County: Pinellas
Sec/Twp/Rge: S08/T28S/R15E

Dear Permittee(s):

The Southwest Florida Water Management District (District) is in receipt of your application for the Environmental Resource Permit modification. Based upon a review of the information you submitted, the application is approved.

Please refer to the attached Notice of Rights to determine any legal rights you may have concerning the District's agency action on the permit application described in this letter.

If approved construction plans are part of the permit, construction must be in accordance with these plans. These drawings are available for viewing or downloading through the District's Application and Permit Search Tools located at www.WaterMatters.org/permits.

The District's action in this matter only becomes closed to future legal challenges from members of the public if such persons have been properly notified of the District's action and no person objects to the District's action within the prescribed period of time following the notification. The District does not publish notices of agency action. If you wish to limit the time within which a person who does not receive actual written notice from the District may request an administrative hearing regarding this action, you are strongly encouraged to publish, at your own expense, a notice of agency action in the legal advertisement section of a newspaper of general circulation in the county or counties where the activity will occur. Publishing notice of agency action will close the window for filing a petition for hearing. Legal requirements and instructions for publishing notices of agency action, as well as a noticing form that can be used, are available from the District's website at www.WaterMatters.org/permits/noticing. If you publish notice of agency action, a copy of the affidavit of publication provided by the newspaper should be sent to the District's Tampa Service Office for retention in this permit's File of Record.

If you have any questions or concerns regarding your permit or any other information, please contact the Environmental Resource Permit Bureau in the Tampa Service Office.

Sincerely,

David Kramer, P.E.
Bureau Chief
Environmental Resource Permit Bureau
Regulation Division

Enclosures: Approved Permit w/Conditions Attached
 [As-Built Certification and Request for Conversion to Operation Phase](#)
 Notice of Authorization to Commence Construction
 Notice of Rights
cc: David Landers
 Ariel Elvambuena, P.E., CPH Corp



FLORIDA DEPARTMENT of STATE

RON DESANTIS
Governor

LAUREL M. LEE
Secretary of State

Ms. Theresa R. Carron
FDEP – Bureau of Design and Construction
3900 Commonwealth Blvd, 260M, MS 530
Tallahassee, FL 32399

January 21, 2020

RE: DHR Project File No.: 2019-8849
Project: Entrance Area Improvements - Provide Additional Entrance Lanes and
Toll Booths to Reduce Traffic Backup
Honeymoon Island State Park, Pinellas County

Dear Ms. Carron:

Our office reviewed the referenced project in accordance with Chapter 267, *Florida Statutes*, and implementing state regulations, for possible effects on historic properties listed, or eligible for listing, in the *National Register of Historic Places*, or otherwise of historical, architectural or archaeological value.

It is the opinion of this agency that ground disturbing activities be periodically monitored by someone who has completed our Archaeological Resource Management (ARM) training program. Once a project is complete, the monitor should submit the appropriate monitoring forms to this agency. In the event that unmarked human remains are encountered during permitted activities, all work shall stop immediately and the proper authorities notified in accordance with Section 872.05, *Florida Statutes*.

For any questions concerning our comments, please contact Robin Jackson, Historic Preservationist, Compliance and Review, by electronic mail at robin.jackson@doh.myflorida.com, or at 850.245.6496, or 800.847.7278.

Sincerely,

Handwritten signature of Jason Aldridge in blue ink, with the word "For" written below it.

Timothy A. Parsons, Ph.D.
Director, Division of Historical Resources and
State Historic Preservation Officer

Carron, Theresa

From: Elvambuena, Ariel (P.E.) <aelvambuena@cphcorp.com>
Sent: Thursday, April 2, 2020 8:58 AM
To: Carron, Theresa
Cc: Toole, Jason L. (P.E.)
Subject: RE: Honeymoon Island Toll Booth, SWFWMD permit approved

Good morning Terri.

As far as the Army Corp, The short answer to your question is no. Here is the thorough answer: ACOE authorization is needed to fill wetlands or surface waters under their jurisdiction. Whether this little area on the south side of the road is ACOE jurisdictional is questionable. I think it is not, because it is not connected to the ditch on the north side of the road, which is directly connected to the bay. It's also questionable because it appears to be a man-made ditch constructed in uplands. Even if the ditch in question were ACOE jurisdictional, there is a Nationwide permit (NWP 14) for linear transportation projects that authorizes up to one half acre of impact to non-tidal waters, and one third acre of tidal waters. In addition, a project proponent is only required to notify the ACOE of an activity covered by NWP 14 if the impact is greater than 0.1 acre. The proposed impact to Wetland 1 is 0.004 acre.

Ariel Elvambuena
Project Manager
o 813.288.0233 (Ext.2408)
AElvambuena@cphcorp.com



Full Service A&E Firm
[Facebook](#) | [LinkedIn](#)

From: Carron, Theresa <Theresa.Carron@dep.state.fl.us>
Sent: Wednesday, April 1, 2020 3:52 PM
To: Elvambuena, Ariel (P.E.) <aelvambuena@cphcorp.com>
Cc: Toole, Jason L. (P.E.) <jtoole@cphcorp.com>
Subject: RE: Honeymoon Island Toll Booth, SWFWMD permit approved

Ari,

Good news on the SWFWMD permit.

Do we need a permit from USACE for this project? What about local/state fire marshal approvals on the toll booth? I need something in the file....an email would work!

When will 100% plans and specifications be complete?



Thank you,

Theresa R. Carron

Department of Environmental Protection
Project Manager
Bureau of Design and Construction
3800 Commonwealth Boulevard 260M, MS 520
Tallahassee, FL 32399
Theresa.Carron@FloridaDEP.gov
O: (850) 245-2721
C: (850) 294-4642

From: Elvambuena, Ariel (P.E.) <aelvambuena@cphcorp.com>
Sent: Tuesday, March 24, 2020 10:31 AM
To: Carron, Theresa <Theresa.Carron@dep.state.fl.us>
Subject: Honeymoon Island Toll Booth, SWFWMD permit approved

Good morning Terri. We received the approved SWFWMD permit. Please see attached. I'm going to be making a formal submittal for subtasks 6A and 6B soon. I will be getting signed and sealed 100% plans to you shortly.

Ariel Elvambuena
Project Manager
o 813.288.0233 (Ext.2408)
AElvambuena@cphcorp.com



Full Service A&E Firm
[Facebook](#) | [LinkedIn](#)





Architects
Environmental
M/E/P
Surveyors

Engineers
Landscape Architects
Planners
Transportation/Traffic

3277A Fruitville Road
Suite 2
Sarasota, FL 34237
Phone: 941.365.4771
Fax: 941.365.4779

Memo

Date: January 2, 2019
To: Ken Francis, FDEP
Copy: Ariel Elvambuena, P.E., CPH
From: David Landers, Senior Environmental Scientist
Re: Honeymoon Island Entrance Improvements – Preliminary Environmental Assessment
 CPH Project No. F13609

CPH, Inc. Environmental Services conducted a preliminary assessment in connection with the proposed improvements at the entrance to Honeymoon Island State Park. The assessment included a review of public records of documented wildlife observations maintained by the Florida Fish and Wildlife Conservation Commission (FFWCC) and U.S. Fish & Wildlife Services (USFWS) and a field investigation. Other resources used included the following: aerial photographs, *Soil Survey of Pinellas County, Florida*; Florida Natural Areas Inventory (FNAI); Official Lists of Endangered and Potentially Endangered Fauna and Flora in Florida (FFWCC); Wildlife Occurrence Database System maintained by FFWCC; and the USFWS website for protected species listings. The proposed improvements include widening of the pavement and construction of an additional ticket booth, along with necessary modifications to the existing detention pond on the north side of the entrance area.

This memorandum summarizes the results of the field investigation and public database search conducted for this assessment. The field investigation was conducted on December 19, 2018. The assessment area is shown on the attached aerial photo.

Existing Conditions

The assessment area is adjacent to and immediately north of the existing entrance drive and ticket booths. The assessment area encompasses a detention pond, an open grassy area with scattered trees and a more densely vegetated area with trees and shrubs. The existing park entrance road with ticket booths is to the south. To the north are a concrete seawall and the waters of St. Joseph Sound. There are numerous trees along the existing edge of pavement that will have to be removed to construct the project. The trees include several cabbage palms (*Sabal palmetto*) and a few live oaks (*Quercus virginiana*) and sea grapes (*Coccoloba uvifera*).

The detention pond is shallow, with a poorly defined top-of-bank. There is a concrete weir structure at the eastern end. The pond is predominantly vegetated with grasses including seashore paspalum (*Paspalum vaginatum*) and saltgrass (*Distichlis spicata*). Other vegetation observed includes marsh pennywort (*Hydrocotyle umbellata*), capeweed (*Phyla nodiflora*), and bushy bluestem (*Andropogon glomeratus*).

The open grassy area is mowed and maintained. The vegetation includes scattered cabbage palms with ground cover consisting of bahiagrass (*paspalum notatum*), thin paspalum (*Paspalum setaceum*), common wireweed (*Sida ulmifolia*) and Spanish needles (*Bidens alba*).

Toward the western end of the assessment area, the vegetation is denser, consisting of cabbage palms, snowberry (*Chiococca alba*) and yaupon holly (*Ilex vomitoria*).

Wetlands and Surface Waters

According to wetland delineation methodologies outlined in the *Corps of Engineers Wetland Delineation Manual* (1987), the *2008 Corps Interim Regional Supplement to the Corps Wetland Delineation Manual: Atlantic & Gulf Coastal Plain Region* and the State of Florida Unified Wetland Delineation Methodology (Section 62-340.300, F.A.C.), **habitats classified as wetlands and surface waters were not observed within the assessment area during the field investigation**. The stormwater detention pond is regulated as part of a stormwater management system, but not as a jurisdictional wetland or surface water.

Protected Species

The USFWS is the federal agency responsible for protecting the nation's fish and wildlife resources through implementation of the Endangered Species Act of 1973, as amended. ("ESA," 16 U.S.G. 1513-1543). The Florida Fish and Wildlife Conservation Commission (FFWCC) regulates the taking of species listed as endangered, threatened or of special concern and their nests through Rules 68A-27.003, 68A-27.004 and 68A-27.005, Florida Administrative Code. The FFWCC also provides technical assistance to other agencies that have regulatory authority over activities that may affect fish and wildlife and their habitat. **The records search did not indicate the presence of species protected under the ESA, or under Rules 68A-27.003, 68A-27.004 and 68A-27.005, Florida Administrative Code within the assessment area. However, one species, the gopher tortoise (*Gopherus polyphemus*), was observed within the assessment area during the on-site field investigation.**

The gopher tortoise is listed as a "Threatened" species by the FFWCC and is protected by state law under Chapter 68A-27, Florida Administrative Code. The gopher tortoise is found throughout Florida and is generally associated with longleaf pine and xeric oak sandhills but is also located in scrub, xeric hammock, pine flatwoods, dry prairie, coastal grasslands and dunes, mixed hardwood-pine and a variety of disturbed

habitats. If the gopher tortoise is observed, or signs of the tortoise such as burrows are observed, their presence must be addressed prior to on-site construction activities. The FFWCC is the state agency responsible for overseeing the management of this species including permitting.

According to the FFWCC there are several options to address project areas slated for development with active gopher tortoise populations. These options include avoidance, on-site relocation and off-site relocation. All FFWCC permit scenarios will require local government approval of the development prior to permit issuance and tortoise relocation. According to FFWCC regulations, project activities within 25 feet of a gopher tortoise burrow will require consultation and permitting to address the presence of the tortoises. The FFWCC will not accept tortoise surveys older than 90 days when a permit application for the relocation is forwarded for their review.

Avoidance - Avoidance involves developing a site that will avoid all burrows by a minimum of 25 feet and leaving enough habitat to allow the tortoise population to survive. Remaining habitat must either be managed for the gopher tortoise or be allowed to remain in its current condition. Tortoises left on undeveloped "islands" will not be allowed. There are no permitting costs associated with this option. **Typically, this option is not practical for most projects.**

On-site Relocation - On-site relocation is an option if the site has potential habitat that will remain in the post development condition that will be managed or protected for the conservation of tortoises. This option includes obtaining an On-site 10 or Fewer Burrows Permit or Conservation Permit from the FFWCC depending on the number of burrows observed and tortoises to be excavated and relocated. The permitting process typically takes 30-60 days. Once a permit is obtained, the permit is valid for up to 6 to 12 months but can be extended for an additional 6 to 12 months prior to expiration. **Since a 10 or fewer burrows permit has already been issued for this property, a conservation permit would be required for on-site relocation of tortoises.**

Off-site Relocation - This option includes obtaining an Off-site 10 or Fewer Burrows Permit or Conservation Permit from the FFWCC by an authorized agent. The permitting process typically takes 30-60 days. Once a permit is obtained, the permit is valid for up to 12 months but can be extended for an additional 6 to 12 months prior to expiration. **Since a 10 or fewer burrows permit has already been issued for this property, a conservation permit would be required for off-site relocation of tortoises. Off-site relocation is a practical option to address the presence of the gopher tortoise burrows within the subject project area.**

Permit & Recipient Site Fees - A flat mitigation contribution from each applicant applies to the first 10 burrows impacted on a project site. Additional mitigation for sites supporting more than 10 tortoise burrows is required. The FFWCC is charging \$213 for the first group of 10 burrows (up to five gopher tortoises) and \$319 (Long-term Protected Recipient Site) or \$3,191 (Short-term Protected Recipient Site) for each

additional tortoise. **This mitigation contribution fee is subject to change based on the number of tortoises captured and relocated. A refund request of the un-used portion of the mitigation contribution fee may be applied for after the relocation has been completed, if applicable. FFWCC will retain 3% of the un-used portion as an administration processing fee.**

The recipient site fees per tortoise are subject to change based on supply and demand. The average fee per tortoise for a Long-term Protected Recipient Site, a fee paid to an entity accepting the relocated tortoises is \$850/tortoise (average price per tortoise for Florida). Should commensal species be found additional fees may apply.

Summary

CPH conducted a preliminary assessment in connection with the proposed widening of the pavement and construction of an additional ticket booth, along with necessary modifications to the existing detention pond,

According to wetland delineation methodologies outlined in the *Corps of Engineers Wetland Delineation Manual* (1987), the *2008 Corps Interim Regional Supplement to the Corps Wetland Delineation Manual: Atlantic & Gulf Coastal Plain Region* and the State of Florida Unified Wetland Delineation Methodology (Section 62-340.300, F.A.C.), habitats classified as wetlands and surface waters were not observed within the assessment area during the field investigation. The stormwater detention pond is regulated as part of a stormwater management, system but not as a jurisdictional wetland or surface water.

One state listed species, the gopher tortoise was observed within the assessment area during the field investigation. According to FFWCC regulations, project activities within 25 feet of a gopher tortoise burrow will require consultation and permitting to address the presence of the tortoise. The FFWCC will not accept tortoise surveys older than 90 days when a permit application is submitted for their review. The physical relocation of the tortoise cannot occur until land clearing permits have been obtained and proof of local government approval has been provided to FFWCC. Since a 10 or fewer burrows permit has already been issued for this property, a conservation permit would be required for either off-site or on-site relocation of tortoises. Typically tortoise relocation activities commence immediately prior to construction if barriers are not in place to prevent tortoises from coming to the project site from off-site areas.

If you have any questions, please contact me at 941-365-4771 or via e-mail at dlanders@cphcorp.com.

Honeymoon Island Entrance Improvements

Preliminary Site Assessment

Legend

 Assessment Area



Google Earth